

project  
MFMRD TANAEA MANEABA

architect  
MISE ARCHITECTURAL UNIT



**TDS**

TECHNICAL DESIGN SERVICES  
ARCHITECTURAL UNIT  
MINISTRY OF INFRASTRUCTURE &  
SUSTAINABLE ENERGY  
PO BOX 498  
BETIO, TARAWA  
REPUBLIC OF KIRIBATI  
PHONE: +686 75126192  
EMAIL: design@mise.gov.ki

**TANAEA MANEABA**

CLIENT: MFMRD  
PROJECT NO: 142402

DWG TITLE:  
**COVER PAGE**

DRAWN BY: Author  
REVIEWED BY: Checker  
DATE: 12/21/15  
SCALE:

DRAWING NUMBER: ISSUE:

**A00**

- LEGEND
- FISHERIES BUILDING
  - BUILDING
  - LAGOON
  - EXISTING FENCE TO BE REMOVE
  - EXISTING MANEABA TO BE DEMOLISH

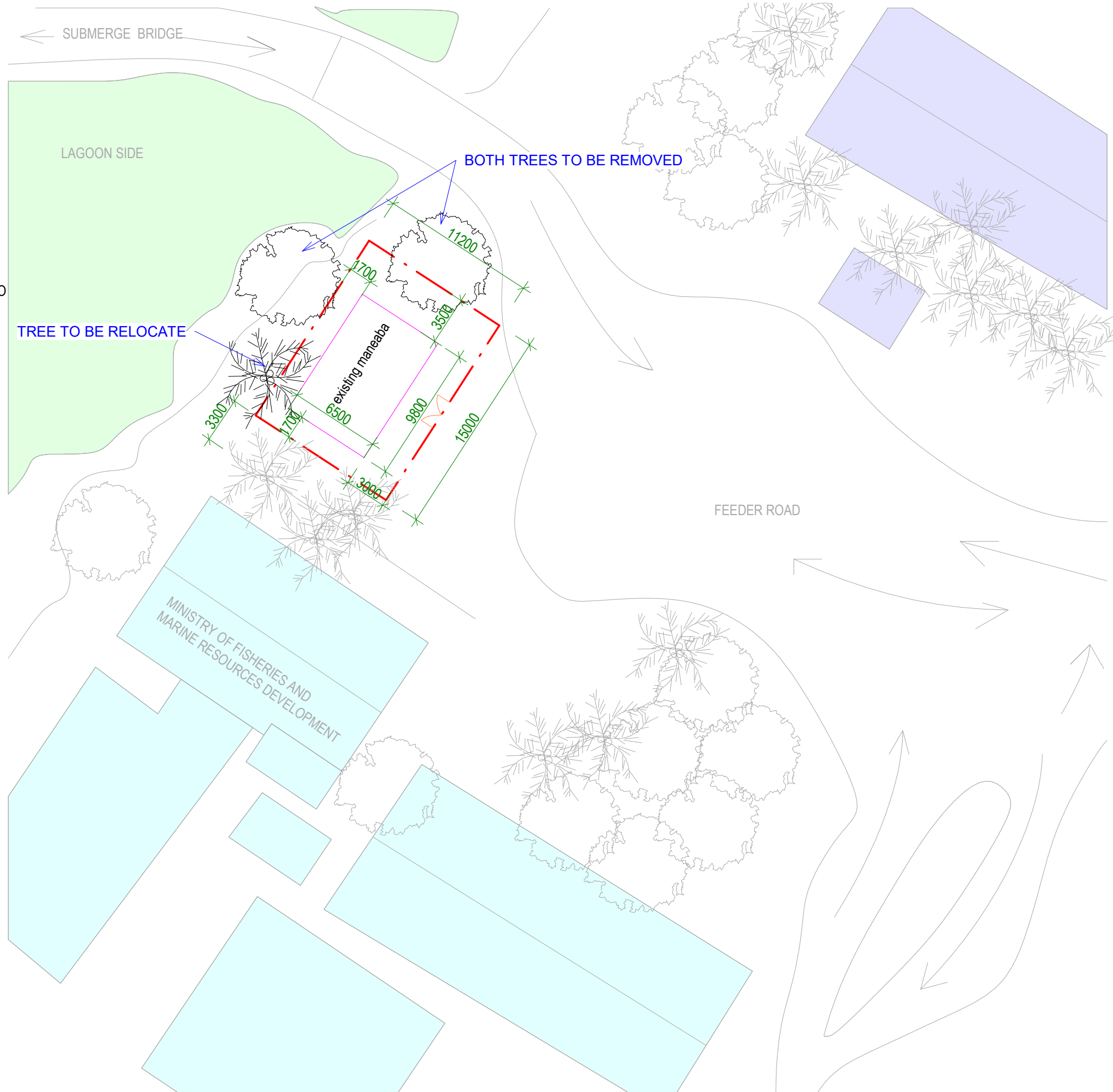

#### SITE SCOPE OF WORKS

- CAREFULLY DEMOLISH AN EXISTING MANEABA
- CLEAR TREES APOINTED IN THE DESIGN

# TDS

TECHNICAL DESIGN SERVICES  
ARCHITECTURAL UNIT  
MINISTRY OF INFRASTRUCTURE &  
SUSTAINABLE ENERGY  
PO BOX 498  
BETIO, TARAWA  
REPUBLIC OF KIRIBATI  
PHONE: +686 75126192  
EMAIL: design@mise.gov.ki

#### TANAEA MANEABA

CLIENT: MFMRD  
PROJECT NO: 142402

DWG TITLE:  
SITE PLAN

DRAWN BY: BR  
REVIEWED BY:  
DATE: 18/04/24  
SCALE: 1 : 300

DRAWING NUMBER: ISSUE:

A01

1

#### SITE

Scale: 1 : 300



- LEGEND
- PROPOSE FENCE
  - PROPOSE DOUBLE GATE
  - PROPOSE SINGLE GATE
  - PROPOSE SEA WALL

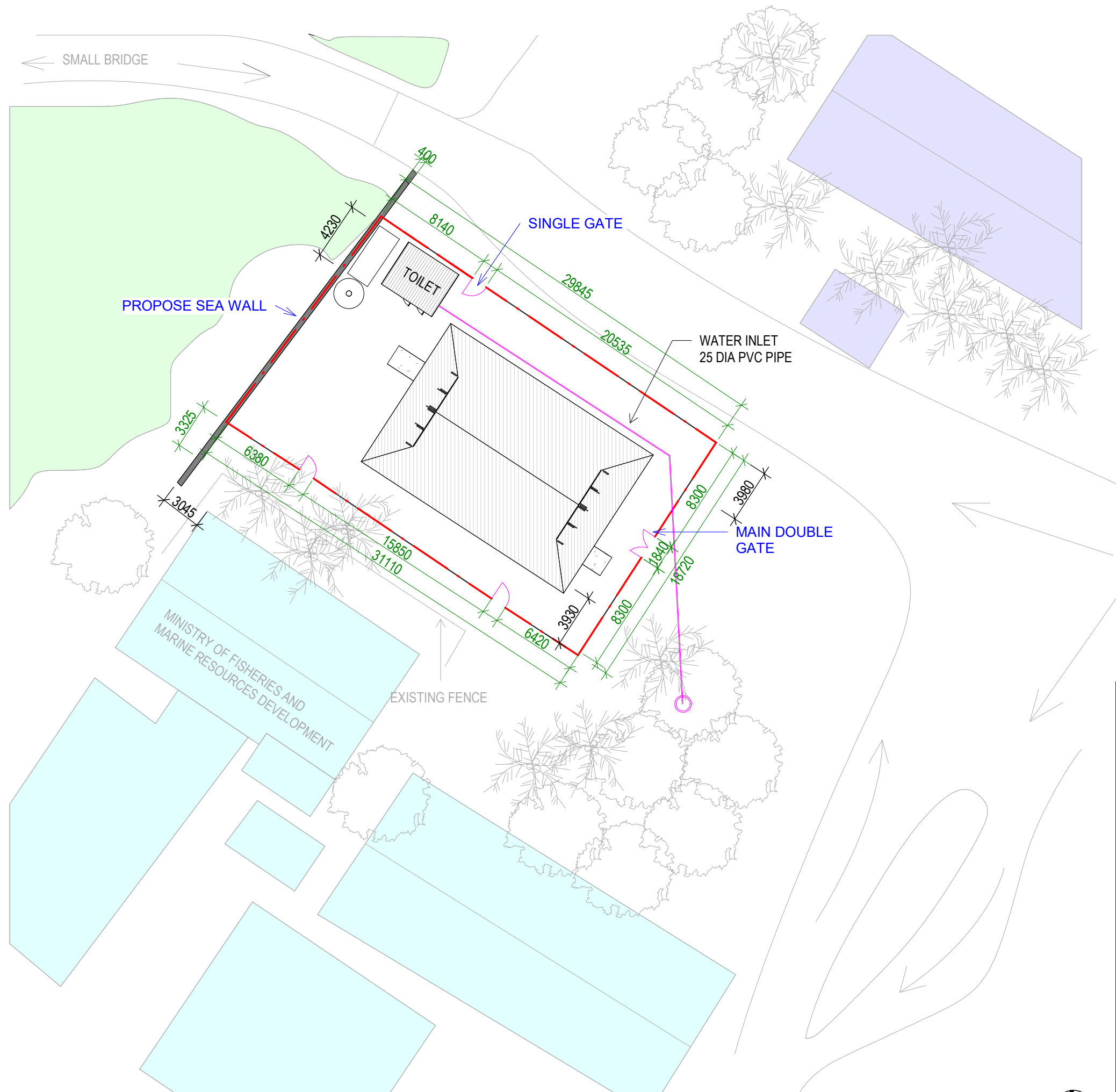

**ADD**

TECHNICAL DESIGN SERVICES  
ARCHITECTURAL UNIT  
MINISTRY OF INFRASTRUCTURE &  
SUSTAINABLE ENERGY  
PO BOX 498  
BETIO, TARAWA  
REPUBLIC OF KIRIBATI  
PHONE: +686 75126192  
EMAIL: design@mise.gov.ki

**TANAEA MANEABA**

CLIENT: MFMRD  
PROJECT NO: 142402

DWG TITLE:  
**PROPOSE SITE**

DRAWN BY: Author  
REVIEWED BY: Checker  
DATE: 12/02/15  
SCALE: 1 : 300

DRAWING NUMBER: ISSUE:

**A02**